

儲物櫃

Locker

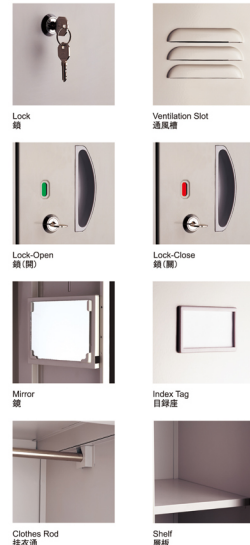

**LKL-3511**  
Single Compartment Full High (with shelf, mirror & clothes rod)  
單層全高儲物櫃  
內置層板、鏡及挂衣通  
W335 x D515 x H1800mm

**LKL-6521**  
2 Compartment Full High (with shelf, mirror & clothes rod)  
雙層全高儲物櫃  
內置層板、鏡及挂衣通  
W616 x D515 x H1800mm

**LKL-9531**  
3 Compartment Full High (with shelf, mirror & clothes rod)  
三層全高儲物櫃  
內置層板、鏡及挂衣通  
W900 x D515 x H1800mm



**LKL-3512**  
2 Compartments 2 Tiers Locker (with clothes rod)  
兩層兩門儲物櫃  
內置挂衣通  
W335 x D515 x H1800mm

**LKL-6522**  
4 Compartments 2 Tiers Locker (with clothes rod)  
兩層四門儲物櫃  
內置挂衣通  
W616 x D515 x H1800mm

**LKL-9532**  
6 Compartments 2 Tiers Locker (with clothes rod)  
兩層六門儲物櫃  
內置挂衣通  
W900 x D515 x H1800mm



**LKL-9433**  
9 Compartments 3 Tiers Locker  
三層九門儲物櫃  
W900 x D450 x H1800mm

**LKL-9434**  
12 Compartments 4 Tiers Locker  
四層十二門儲物櫃  
W900 x D450 x H1800mm

**LKL-9435**  
15 Compartments 5 Tiers Locker  
五層十五門儲物櫃  
W900 x D450 x H1800mm

Cabinet Model:  
文件櫃型號:  
LKL - 9434  
Series 系列: LK - LINK 連結  
LK: LINK 連結  
Type 類別: L: Locker 儲物櫃  
Width 寬度: 1-3: 335mm, 6: 616mm, 9: 900mm  
Row No. 列數: 1-5  
Column No. 行數: 1-3  
Depth 深度: 4: 450mm, 5: 515mm

Color:  
顏色:  
SW-004  
SW-052  
SW-053

\*Remark: In case of discrepancy between this color and the metal prototype, the latter will prevail.  
此色樣與金屬樣板如有任何差異, 以金屬樣板為準。

圖櫃及架

Map Cabinet & Rack



**LKM-104DR**  
4 Drawers Map Cabinet (A0 Size)  
四斗圖櫃 (A0 規格圖)  
W1375 x D990 x H521mm

**LKM-114DR**  
4 Drawers Map Cabinet (A1-A3 Size)  
四斗圖櫃 (A1-A3 規格圖)  
W1220 x D915 x H521mm

**LKM-117DR**  
7 Drawers Map Cabinet (A1-A3 Size)  
七斗圖櫃 (A1-A3 規格圖)  
W1220 x D915 x H826mm



**LKM-100VC**  
Vertical Map Cabinet (A0 Size)  
垂直圖櫃 (A0 規格圖)  
W990 x D510 x H1450mm

**LKM-100RA**  
Map Rack (with 4 pcs A0 size map clips)  
圖架 (含四隻 A0 規格圖夾)  
W1006 x D410 x H1300mm

**LKM-110RA**  
Map Rack (with 4 pcs A1-A3 size map clips)  
圖架 (含四隻 A1-A3 規格圖夾)  
W756 x D410 x H950mm

Map Cabinet / Rack Model:  
圖櫃 / 架型號:  
LKM - 117DR  
Series 系列: DR: Drawer Type 斗櫃類, RA: Rack 架類, VC: Vertical Type 垂直櫃類  
LK: LINK 連結, Type 類別: M: Map 圖櫃/架  
Map Size 圖架: 10: A0 Size, 11: A1 Size  
No. of Drawer 斗數: 0: 無, 4: 4 Drawer 斗, 7: 7 Drawer 斗  
Feature 功能:  
Color:  
顏色:  
SW-004  
SW-007

\*Remark: In case of discrepancy between this color and the metal prototype, the latter will prevail.  
此色樣與金屬樣板如有任何差異, 以金屬樣板為準。

活動橫移組合櫃

Sliding Type Cabinet

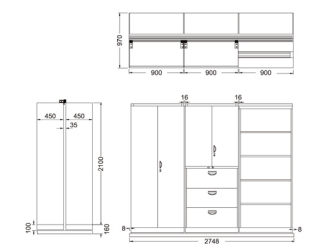
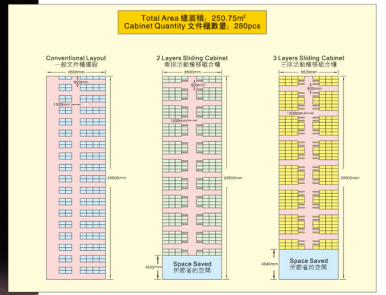

2 Layers Sliding Cabinet  
兩層活動橫移組合櫃  
LKS-0202 2 Layer 2 Link Unit 兩層 (第一、二格)  
LKS-0203 2 Layer 3 Link Unit 兩層 (第一、二、三格)  
LKS-0204 2 Layer 4 Link Unit 兩層 (第一、二、三、四格)  
LKS-0205 2 Layer 5 Link Unit 兩層 (第一、二、三、四、五格)  
LKS-0206 2 Layer 6 Link Unit 兩層 (第一、二、三、四、五、六格)  
LKS-0201 2 Layer Extension Unit 兩層增進配件



LKA-LS  
Lock for sliding base  
底座鎖

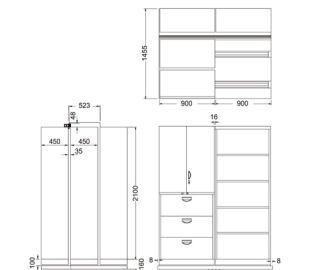

3 Layers Sliding Cabinet  
三層活動橫移組合櫃  
LKS-0302 3 Layer 2 Link Unit 三層 (第一、二格)  
LKS-0303 3 Layer 3 Link Unit 三層 (第一、二、三格)  
LKS-0304 3 Layer 4 Link Unit 三層 (第一、二、三、四格)  
LKS-0305 3 Layer 5 Link Unit 三層 (第一、二、三、四、五格)  
LKS-0306 3 Layer 6 Link Unit 三層 (第一、二、三、四、五、六格)  
LKS-0301 3 Layer Extension Unit 三層增進配件



LKA-SD  
Sliding Door  
橫移門

Cabinet Model:  
文件櫃型號:  
LKS - 0203  
Series 系列: No. of Bay 連數: DR: Drawer Type 斗櫃類, RA: Rack 架類, VC: Vertical Type 垂直櫃類  
LK: LINK 連結, Type 類別: S: Sliding 活動橫移組合  
M: Map 圖櫃/架  
Map Size 圖架: 10: A0 Size, 11: A1 Size  
No. of Drawer 斗數: 0: 無, 2: 2 Layer 用, 3: 3 Layer 用  
Feature 功能:  
Color:  
顏色:  
SW-004  
SW-021

\*Remark: In case of discrepancy between this color and the metal prototype, the latter will prevail.  
此色樣與金屬樣板如有任何差異, 以金屬樣板為準。

連格

文件櫃系列



LINK SERIES CABINET

LITTON 利通貿易工程有限公司  
LITTON TRADING & ENGINEERING LTD.  
澳門氹仔沙塘咀馬路45號利通工業中心2樓207號N座  
Est. Mar da Arca Preta Nº 45, Edif. Industrial Politéc. Fase II, 7 andar N, Macau  
Tel: 2870 1830 Fax: 2870 1630 E-mail: info@kamlitton.com  
www.kamlitton.com



## 組合式文件櫃 Combination Type Cabinet

### FEATURES 特點

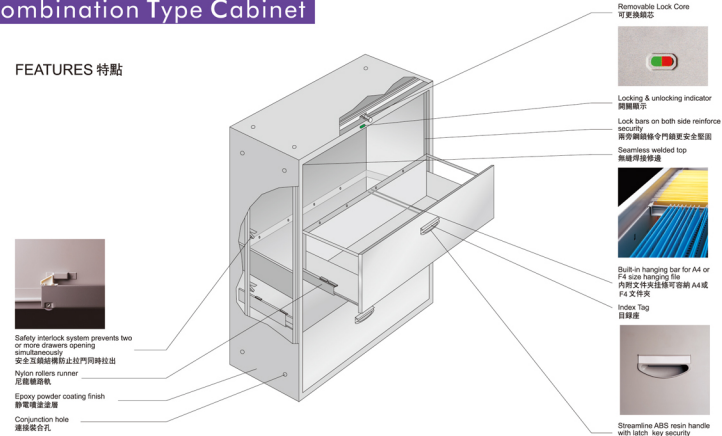

- Removable Lock Core 可更換鎖芯
- Locking & unlocking indicator 開鎖顯示
- Lock bars on both side reinforce security 兩旁鎖條強化門鎖更安全可靠
- Seamless welded top 無縫焊接頂蓋
- Built-in hanging bar for A4 or F4 size hanging file 內嵌文件掛架適合掛 A4 或 F4 文件夾
- Knock tag 防撞條
- Streamline ABS resin handle with touch key security 流線型塑料觸控式拉手
- Safety interlock system prevents two or more drawers opening simultaneously 安全互鎖機構防止拉門同時拉出
- Nylon rollers runner 尼龍滾珠
- Epoxy powder coating finish 靜電噴塗塗層
- Conduction hole 導電孔

### Cabinet Height 組合櫃高度(mm)



**LKC-0907DAL**  
2 Drawers Lateral File (for A4/F4 Size hanging file)  
橫掛三斗櫃 (可掛 A4 或 F4 文件夾)  
W900 x D450 x H700mm



**LKC-0907SSU**  
Sliding Door Cabinet (Upper)  
移門櫃 (上層用)  
W900 x D450 x H700mm



**LKC-0907SSL**  
Sliding Door Cabinet (Lower)  
移門櫃 (下層用)  
W900 x D450 x H700mm



**LKC-0907GSU**  
Sliding Glass Door Cabinet (Upper)  
玻璃移門櫃 (上層用)  
W900 x D450 x H700mm



**LKC-0907CAU**  
Double Swing Door Cabinet (Upper)  
雙門櫃 (上層用)  
W900 x D450 x H700mm



**LKC-0907CAL**  
Double Swing Door Cabinet (Lower)  
(Must be used with Base)  
雙門櫃 (下層用) (必須配合底座使用)  
W900 x D450 x H700mm



**LKC-0907BCU**  
Double Swing Glass Door Cabinet (Glass) (Upper)  
玻璃雙門櫃 (上層用)  
W900 x D450 x H700mm



**LKC-0907ABU**  
Open Shelf Cabinet (Upper)  
開門櫃 (上層用)  
W900 x D450 x H700mm



**LKC-0907ABL**  
Open Shelf Cabinet (Lower)  
開門櫃 (下層用)  
W900 x D450 x H700mm



**LKC-0907MAG**  
2-high Magazine Cabinet  
兩層雜誌櫃  
W900 x D450 x H700mm



**LKC-0910DAL**  
3 Drawers Lateral File  
橫掛三斗櫃 (可掛 A4 或 F4 文件夾)  
W900 x D450 x H1050mm



**LKC-0910DBL**  
4 Drawers Lateral File  
橫掛四斗櫃 (可掛 A4 或 F4 文件夾)  
W900 x D450 x H1050mm



**LKC-0910DCL**  
6 Drawers Lateral File  
橫掛六斗櫃  
W900 x D450 x H1050mm



**LKC-0910SSU**  
Sliding Door Cabinet (Upper)  
移門櫃 (上層用)  
W900 x D450 x H1050mm



**LKC-0910SSL**  
Sliding Door Cabinet (Lower)  
移門櫃 (下層用)  
W900 x D450 x H1050mm



**LKC-0910CAU**  
Double Swing Door Cabinet (Upper)  
雙門櫃 (上層用)  
W900 x D450 x H1050mm



**LKC-0910CAL**  
Double Swing Door Cabinet (Lower)  
(Must be used with Base)  
雙門櫃 (下層用) (必須配合底座使用)  
W900 x D450 x H1050mm



**LKC-0910BCU**  
Double Swing Glass Door Cabinet (Glass) (Upper)  
玻璃雙門櫃 (上層用)  
W900 x D450 x H1050mm



**LKC-0910ABU**  
Open Shelf Cabinet (Upper)  
開門櫃 (上層用)  
W900 x D450 x H1050mm



**LKC-0910ABL**  
Open Shelf Cabinet (Lower)  
開門櫃 (下層用)  
W900 x D450 x H1050mm



**LKC-0910GSU**  
Sliding Glass Door Cabinet (Upper)  
玻璃移門櫃 (上層用)  
W900 x D450 x H1050mm



**LKC-0910MAG**  
3-high Magazine Cabinet  
三層雜誌櫃  
W900 x D450 x H1050mm



**LKC-0914DAL**  
4 Drawers Lateral File  
橫掛四斗櫃 (可掛 A4 或 F4 文件夾)  
W900 x D450 x H1400mm



**LKC-0914SSL**  
Sliding Door Cabinet (Lower)  
移門櫃 (下層用)  
W900 x D450 x H1400mm



**LKC-0914ABL**  
Open Shelf Cabinet (Lower)  
開門櫃 (下層用)  
W900 x D450 x H1400mm



**LKC-0914MAG**  
4-high Magazine Cabinet  
四層雜誌櫃  
W900 x D450 x H1400mm



**LKC-0914CAL**  
Double Swing Door Cabinet (Lower)  
(Must be used with Base)  
雙門櫃 (下層用) (必須配合底座使用)  
W900 x D450 x H1400mm



**LKC-0921SSL**  
Sliding Door Cabinet  
移門櫃  
W900 x D450 x H2100mm



**LKC-0921CAL**  
Double Swing Door Cabinet  
雙門櫃 (必須配合底座使用)  
W900 x D450 x H2100mm



**LKC-0921ABL**  
Open Shelf Cabinet  
開門櫃  
W900 x D450 x H2100mm

## 配件 Accessories

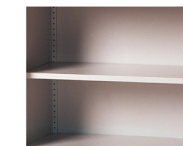

**LKA-09RS**  
Adjustable Shelf  
層板  
W892 x D358 x H20mm



**LKA-09HR**  
Double Rod  
雙掛架  
W892 x D358 x H20mm

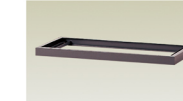

**LKA-09AB**  
Base  
底座  
W900 x D425 x H54mm



**LKC-0904CAU**  
Double Swing Door Cabinet (Upper)  
雙門櫃 (上層用)  
W900 x D450 x H420mm



Color: 顏色: SW-04 SW-021  
\*Remark: In case of discrepancy between this color and the metal prototype, the latter will prevail.  
此色樣與金屬樣板存在色度差異, 以金屬樣板為準。

- Accessories Model: 配件型號: LKA-09MS
- Series 系列: LK: LINK 連格
  - Type 類別: A: Accessories 配件
  - Feature 功能: AB: Base 底座, HR: Double Rod 雙掛架, RS: Adjustable Shelf 層板
  - Width 寬度: 09: 900mm

- Cabinet Model: 文件櫃型號: LKC-0907DAL
- Series 系列: LK: LINK 連格
  - Type 類別: C: Combination 組合式櫃
  - Width 寬度: 09: 900mm
  - Height 高度: 04: 420mm, 07: 700mm, 10: 1050mm, 14: 1400mm, 21: 2100mm
  - Feature 功能: ABL: Open Shelf Cabinet (Lower) 開門櫃 (下層用), ABU: Open Shelf Cabinet (Upper) 開門櫃 (上層用), BCU: Double Swing Glass Door Cabinet (Glass) (Upper) 玻璃雙門櫃 (上層用), CAL: Double Swing Door Cabinet (Lower) 雙門櫃 (下層用), CAU: Double Swing Door Cabinet (Upper) 雙門櫃 (上層用), DAL: Lateral File 橫掛三斗櫃, DBL: Lateral File 橫掛四斗櫃, DCU: Sliding Glass Door Cabinet (Upper) 玻璃移門櫃 (上層用), GCU: Sliding Glass Door Cabinet (Lower) 玻璃移門櫃 (下層用), MAG: Magazine Cabinet 雜誌櫃, SSL: Sliding Door Cabinet (Lower) 移門櫃 (下層用), SSU: Sliding Door Cabinet (Upper) 移門櫃 (上層用)

## 文件櫃及活動臺底櫃 Filing Cabinet & Mobile Pedestal



**LKD-0407AD**  
2 Drawers Vertical File (for A4/F4 hanging file)  
直掛兩斗櫃 (可掛 A4 或 F4 文件夾)  
W457 x D635 x H711mm



**LKD-0410BD**  
3 Drawers Vertical File (for A4/F4 hanging file)  
直掛三斗櫃 (可掛 A4 或 F4 文件夾)  
W457 x D635 x H1018mm



**LKD-0413CD**  
4 Drawers Vertical File (for A4/F4 hanging file)  
直掛四斗櫃 (可掛 A4 或 F4 文件夾)  
W457 x D635 x H1320mm



**LKSD-0413CD**  
4-high Vertical File (for A4/F4 hanging file)  
直掛四層櫃 (可掛 A4 或 F4 文件夾)  
W457 x D635 x H1320mm



**LKMP-0406AD**  
2 Drawers Mobile Pedestal  
兩斗活動臺底櫃  
W400 x D500 x H650mm



**LKMP-0406BD**  
3 Drawers Mobile Pedestal  
三斗活動臺底櫃  
W400 x D500 x H650mm



**LKMP-0406DD**  
3 Drawers Mobile Pedestal (for A4/F4 hanging file)  
三斗活動臺底櫃 (可掛 A4 或 F4 文件夾)  
W400 x D500 x H650mm



Color: 顏色: SW-04 SW-021  
\*Remark: In case of discrepancy between this color and the metal prototype, the latter will prevail.  
此色樣與金屬樣板存在色度差異, 以金屬樣板為準。